

### Saw Creek Estates Map Legend:

- A- Front Gate (570) 588-9395
- B- The Falls Community (570) 223-1133
- C- Administration Office (570) 588-9329
- D- V.I.P. Recreation Complex (570) 588-5938
- E- Security Office (570) 588-5151
- F- Top of the World Recreation Complex (570) 588-6668
- F- Top of the World Restaurant (570) 588-6600
- G- Top of the World Ski Area (570) 588-9266
- H- Mt. Side Pool (570) 588-9345
- I- Back Gate (570) 588-6380
- J- Mill Pond Recreation Complex (570) 588-6946
- K- Mill Pond Town Homes
- L- Compactor Area
- M- Recycling Center

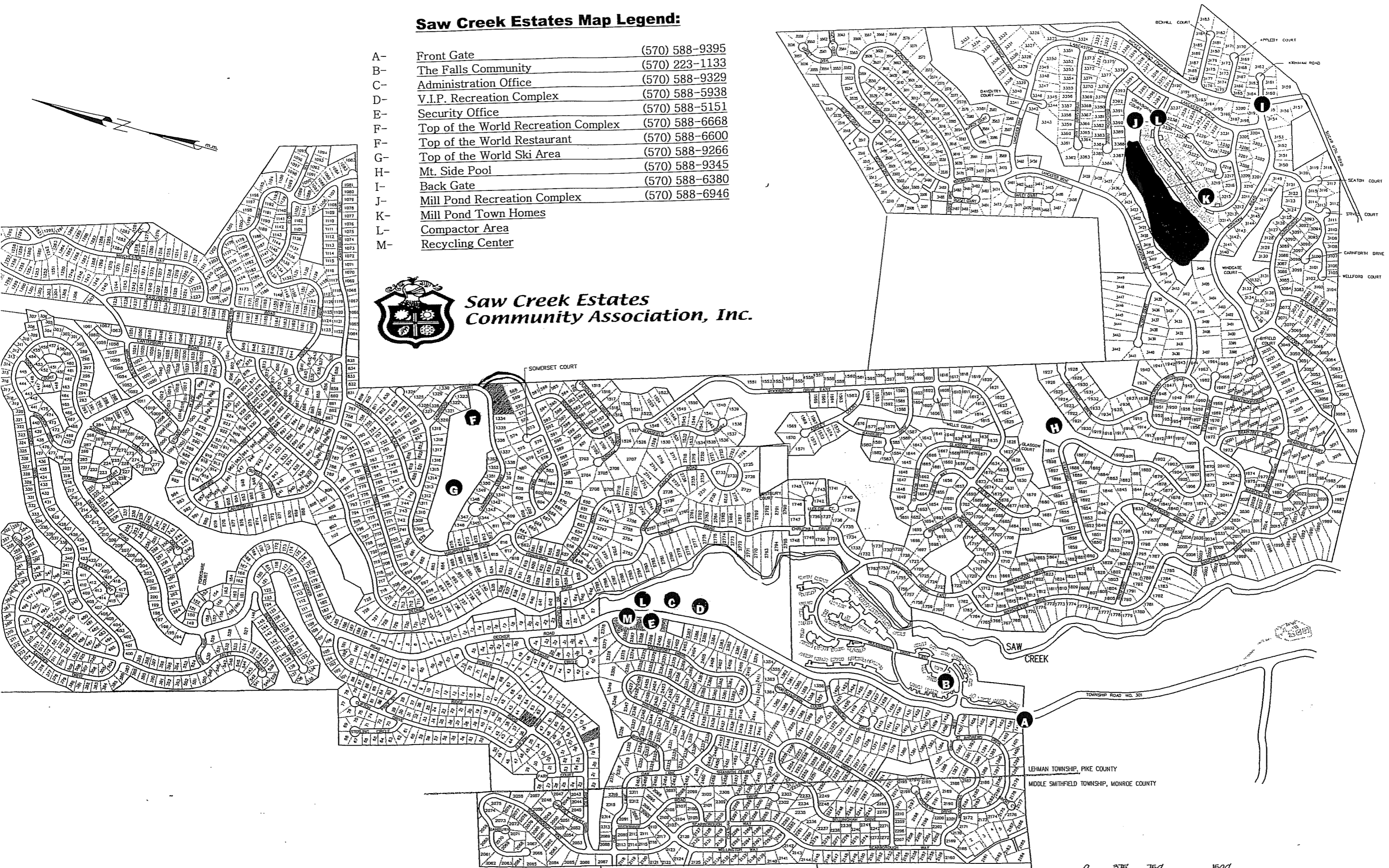

**Saw Creek Estates  
Community Association, Inc.**



LEHMAN TOWNSHIP, PIKE COUNTY  
MIDDLE SMITHFIELD TOWNSHIP, MONROE COUNTY

TOWNSHIP ROAD